



GUTEX® Thermowall/NF/-gf/-L Data Sheet



Photographic images are property of GUTEX archive; HUF house

GUTEX Thermowall, a single-ply plaster baseboard with homogenous cross section, is the ideal choice for use with GUTEX's environment-friendly external thermal insulation composite system (ETICS).

Technical Data	Thermowall®					Thermowall® NF	Thermowall®-gf			Thermowall®-L ¹⁾						
Joint type	butted				tongue and groove		tongue and groove	tongue and groove		butted		butted				
Thickness (mm)	20/40/60/80	100/120/140/160	80/100/120		80/100/120	140/160	60	40/60	60	40/60	120	140	160	180	200	
Length (mm)	1250	830	2600	2800	1300		1800	1300	1800	2600/2800		1250				
Width (mm)	590	600	1250		600		600	600	600	1250		590				
Actual coverage, length x width (mm)					1276x576	1280x580	1780x580	1276x576	1776x576							
Square metres per board (m ²)	0.738	0.498	3.25	3.5	0.78		1.08	0.78	1.08	3.25/3.5		0.738				
Weight per board (kg)	2.4/4.7/7.1/9.4	8.0/9.6/11.2/12.7	41.6/52/62.4	44.8/56/67.2	10.0/12.5/15.0	17.5/20.0	10.4	5.7/8.66	11.95	24.05/36.08/25.9/38.85		9.74	11.36	12.98	14.6	16.23
Weight per m ² (kg)	3.2/6.4/9.6/12.8	16/19.2/22.4/25.6	12.8/16/19.2		12.8/16.0/19.2	22.4/25.6	9.6	7.4/11.1	11.1	7.4/11.1		13.2	15.4	17.6	19.8	22
Boards per pallet	224/112/70/56	42/32/28/24	12/9/8		54/44/36	32/28	34	108/72	34	24/15		36	32	28	24	22
Square metres per pallet (m ²)	165.2/82.6/51.63/41.3	20.92/15.94/13.94/11.95	39/29.25/26	42/31.5/28	42.12/34.32/28.08	24.96/21.84	36.72	84.24/56.16	36.72	78/48.75/84/52.5		26.55	23.6	20.65	17.7	16.23
Weight per pallet (kg)	540	320	520	560	560		370	650	460	610/570/650/610		370				
Bulk density (kg/m ³)	~ 160						~ 160	~ 185			~ 110					
Vapour diffusion factor (μ)	4						4	3			3					
sd-value (m)	0.08/0.16/0.24/0.32	0.40/0.48/0.56/0.64	0.32/0.40/0.48		0.32/0.40/0.48	0.56/0.64	0.24	0.12/0.18	0.18	0.12/0.18		0.36	0.42	0.48	0.54	0.60
Compressive stress/strength (kPa)	100						100	150			50					
Tensile strength perpendicular to board surface (kPa)	10						10	20			7.5					
Short-term water absorption (kg/m ²)	≤ 1.0						≤ 1.0	≤ 1.0			≤ 1.0					
Air flow resistivity (kPa s/m ²)	100						100	100			100					
Specific heat capacity (J/kgK)	2100						2100	2100			2100					
Fire reaction Euro Class as per DIN EN 13501-1	E						E	E			E					
European Union																
Nominal thermal conductivity λ _D (W/mK)	0.040						0.040	0.043			0.038					
Nominal thermal resistance R _D (m ² K/W)	0.50/1.00/1.50/2.00	2.50/3.00/3.50/4.00	2.50/3.00/3.50		2.00/2.50/3.00	3.50/4.00	1.50	0.90/1.35	1.35	0.90/1.35		3.15	3.65	4.20	4.70	5.25



Designation Thermowall®: WF-EN 13171-T5-WS1,0-DS(70,-)2-CS(10/Y)100-TR10-MU4-AFr100
 Designation Thermowall®-gf: WF-EN 13171-T5-WS1,0-DS(70,-)3-CS(10/Y)200-TR30-MU3-AFr100
 Designation Thermowall®-L: WF-EN 13171-T5-WS1,0-DS(70,-)3-CS(10/Y)50-TR7,5-MU3-AFr100
 German disposal category: A2 (treated wood; without non-halogenated organic compounds);
 code number as per AVV-030105; 170201
 1) Applied for registration

Composition

- Manufactured from untreated Black Forest spruce and fir
- Additives:
 - 4.0 % polyurethane resin (binder)
 - 1.5% paraffin (hydrophobic agent)

Applications

- Plaster baseboard for GUTEX Thermowall external thermal insulation composite system installed over non-vented wood and masonry walls.

Advantages

- Very effective acoustic insulation
- Impact resistant
- Superior thermal storage capacity provides outstanding insulation against heat in the summer and cold in winter.
- Water vapour diffusion permeable
- Wood is a sustainable, recyclable natural resource
- Made in Germany
- Biologically safe (natureplus® certified)

Detail Drawings

Over Timber or Masonry

Product	Length x Width (cm)	Thickness (mm)	Joint	λ_D W/mK
GUTEX Thermowall	60 x 130	80 / 100 / 120 / 140 / 160	T&G	0.040
	125 x 260/280	80 / 100 / 120	butted	0.040
	59 x 125	20 - 80	butted	0.040
	60 x 83	100 - 160	butted	0.040
GUTEX Thermowall-nf	60 x 180	60	T&G	0.040
GUTEX Thermo-wall@-L	59 x 125	120 - 200	butted	0.038

Over Timber Wall

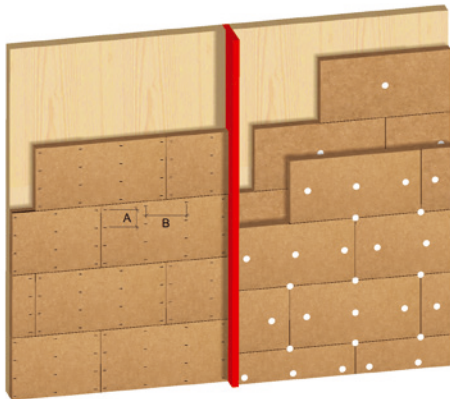

Over Masonry

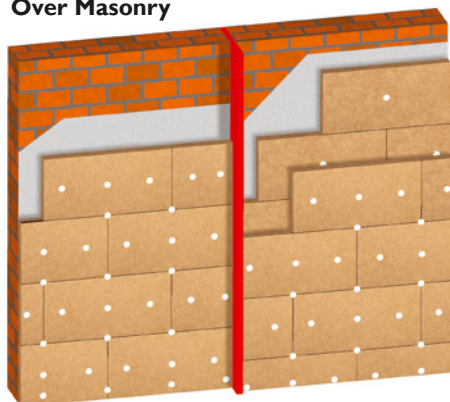

Installation

- Vacuum off the dust in accordance with applicable workplace safety regulations or practices.
- For more detailed information and instructions about installation, fastening and render, see GUTEX's brochure "External Thermal Insulation Composite System."

Timber Frame

Product	Length x Width (cm)	Thickness (mm)	Joint	λ_D W/mK
GUTEX Thermowall-gf	60 x 130	40 / 60	T&G	0.043
	125 x 260/280	40 / 60	butted	0.043
	60 x 180	60	T&G	0.043
GUTEX Thermowall	60 x 130	80 / 100 / 120 / 140 / 160	T&G	0.040
	125 x 260/280	80 / 100 / 120 /	butted	0.040

In Timber Frame

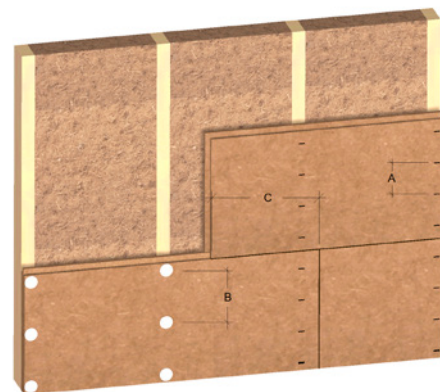

All rights reserved. Henselmann GmbH + Co KG is not liable for any damage resulting from error or misprinting. The technical data provided herein is subject to change. Although all of the information was current at the time of its publication, the publication of superseding

information renders the old information invalid.

The suitability of this product for applications not specified in this data sheet is not guaranteed. Warranty and liability claims are subject to the terms of GUTEX's General Terms of Business.



NATURALLY MADE FROM WOOD